

CRYSTAL ENDEAVOR | DECK PLANS

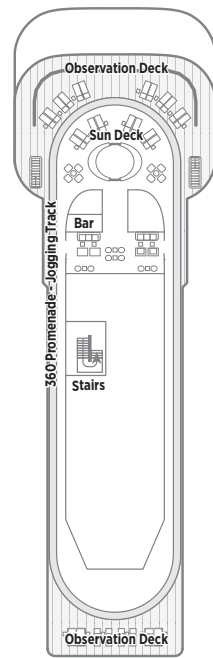

SUNSET DECK 10

Sun Deck

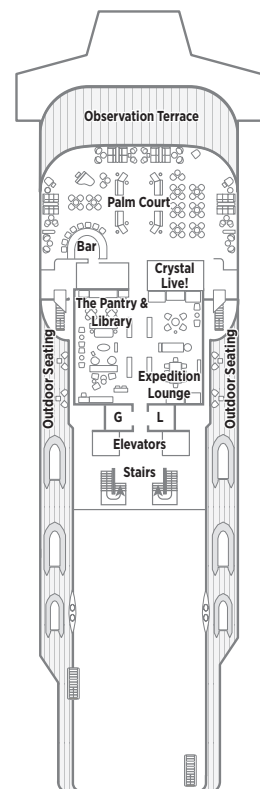

HORIZON DECK 9

Crystal Live!
Expedition Lounge
Palm Court
The Pantry & Library

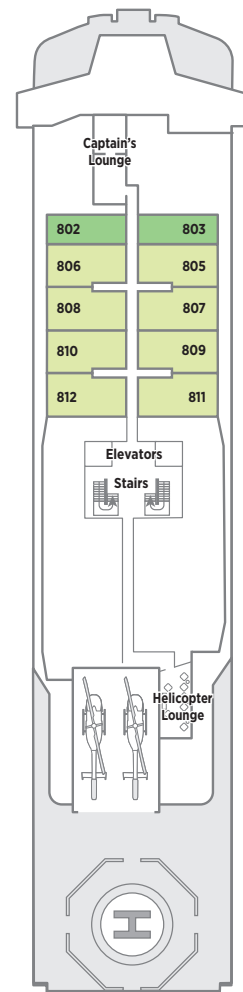

PENTHOUSE DECK 8

Captain's Lounge
Guest room categories PS & S4
Helicopter Lounge

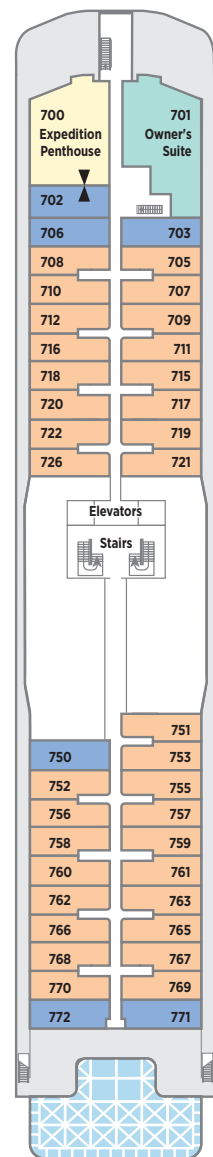

SEABREEZE DECK 7

Guest room categories ES, OS, EP, S1 & S5

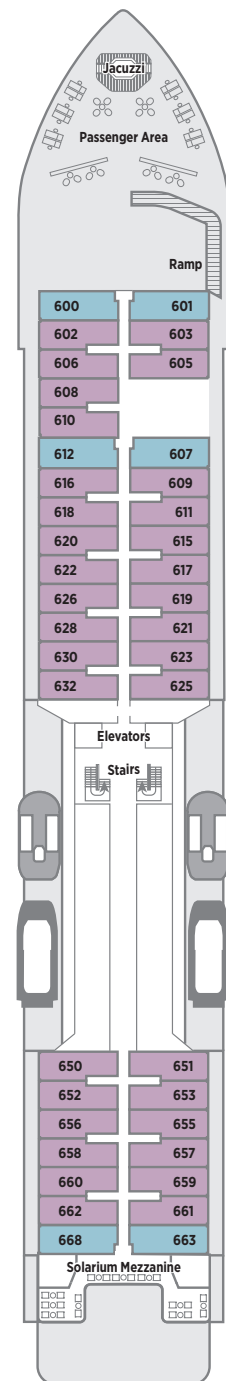

HARMONY DECK 6

Guest room categories S2 & S6
Solarium Mezzanine

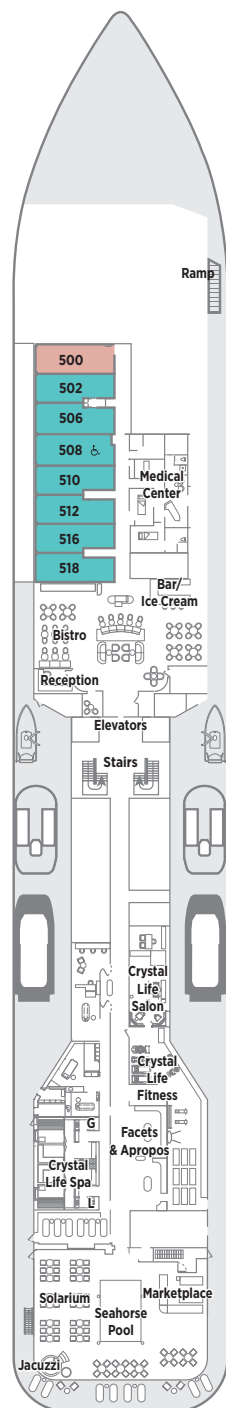

SEAHORSE DECK 5

Bistro
Crystal Life Fitness
Crystal Life Salon
Crystal Life Spa
Facets & Apropops
Guest room categories S3 & S7
Medical Center
Reception
Solarium/Seahorse Pool/Marketplace

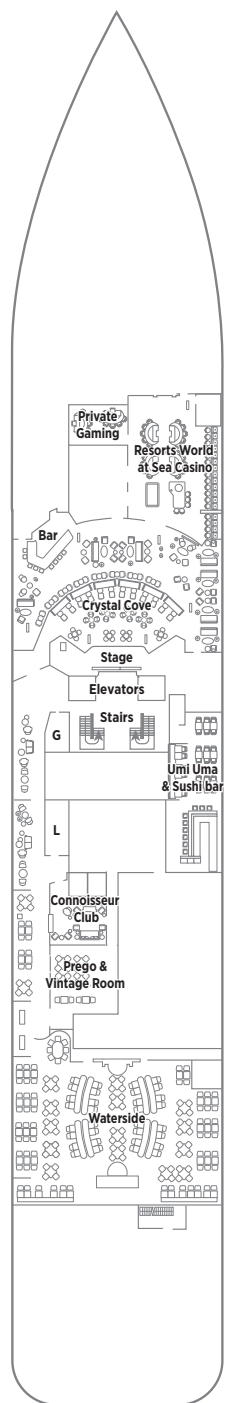

CRYSTAL DECK 4

Connoisseur Club
Crystal Cove
Prego & The Vintage Room
Resorts World at Sea Casino
Private Gaming
Umi Uma & Sushi Bar
Waterside

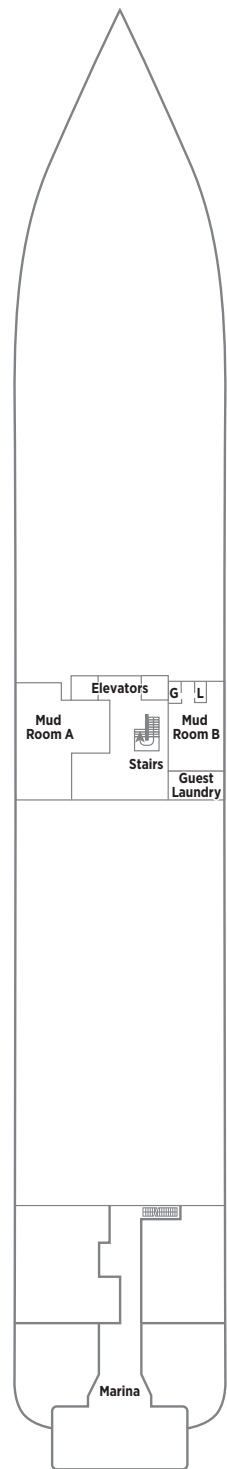

MARINA DECK 3

Guest Laundry
Marina
Mud Rooms

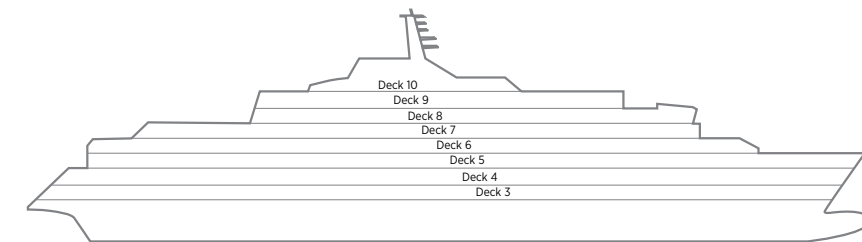

Sunset Deck.....	10	Seabreeze Deck.....	7	Crystal Deck	4
Horizon Deck.....	9	Harmony Deck	6	Marina Deck.....	3
Penthouse Deck.....	8	Seahorse Deck	5		

SUITE CATEGORIES

ES EXPEDITION SUITE (EP + S5) 1,290 SQ. FT. (119.8 SQ. M.)	SEABREEZE DECK 7
OS OWNER'S SUITE (STARBOARD) 1,130 SQ. FT. (105 SQ. M.)	SEABREEZE DECK 7
EP EXPEDITION PENTHOUSE (PORT) 985 SQ. FT. (91.5 SQ. M.)	SEABREEZE DECK 7
PS PENTHOUSE SUITE 457 SQ. FT. (42.5 SQ. M.)	PENTHOUSE DECK 8
S1 S2 S3 S4	PENTHOUSE DECK 8
S5 S6 S7 DELUXE SUITE 304 SQ. FT. (28.3 SQ. M.)	SEABREEZE DECK 7
	HARMONY DECK 6
	SEAHORSE DECK 5

*Please note, dimensions featured above do not include verandahs.

SPECIFICATIONS

GUEST CAPACITY	200
STAFF TO GUEST RATIO	1 TO 1

- Staterooms for guests with disabilities
- Connecting staterooms

CRYSTAL ENDEAVOR | SUITE DESCRIPTIONS



EXPEDITION SUITE (EP + S5) 1,290 SQ. FT. (119.8 SQ. M.) PLUS 735 SQ.FT. (68.3 SQ.M.) VERANDAH

ES

- Spacious living area
- Dining area
- Two separate bedroom areas
- King-size bed (convertible to two twin beds) featuring upholstered headboard with integrated reading lights
- King-size pillows and fine Egyptian cotton linens
- Nightstands with 220V power and USB outlets
- Desk/bar area with refrigerator and integrated power outlets
- Custom shelving and bar amenities
- Nespresso® coffee machine
- 65" Ultra-thin OLED TV
- Personal Safe
- Full-length mirror
- Blackout curtains and sheers
- Double vanity with back-lit mirrors
- Full Jacuzzi® bathtub
- Separate Water Closet with wash basin
- Glass-enclosed rain head shower with both overhead and handheld showerheads
- Separate half-bath / powder room for guests
- ETRO terry robes, slippers and bath amenities
- Electronic "Do Not Disturb" Doorbell
- Storage Closet for Expedition Gear located in corridor adjacent to suite
- 24-hour Butler Service

OWNER'S SUITE (STARBOARD) 1,130 SQ. FT. (105 SQ. M.) PLUS 737 SQ.FT. (68.5 SQ.M.) VERANDAH

OS

- Spacious living area
- Dining area
- Two separate bedroom areas
- King-size bed (convertible to two twin beds) featuring upholstered headboard with integrated reading lights
- King-size pillows and fine Egyptian cotton linens
- Nightstands with 220V power and USB outlets
- Desk/bar area with refrigerator and integrated power outlets
- Custom shelving and bar amenities
- Nespresso® coffee machine
- 65" Ultra-thin OLED TV
- Personal Safe
- Full-length mirror
- Blackout drapery and sheers
- Double vanity with back-lit mirrors
- Full Jacuzzi® bathtub
- Separate half-bath / powder room for guests
- Separate Water Closet with wash basin
- Glass-enclosed rain head shower with both overhead and handheld showerheads
- ETRO terry robes, slippers and bath amenities
- Electronic "Do Not Disturb" Doorbell
- Storage Closet for Expedition Gear located in corridor adjacent to suite
- 24-hour Butler Service

EXPEDITION PENTHOUSE (PORT) 985 SQ. FT. (91.5 SQ. M.) PLUS 683.5 SQ.FT.(63.5 SQ.M.) VERANDAH

EP

- Spacious living area
- Dining area
- Separate bedroom area
- King-size bed (convertible to two twin beds) featuring upholstered headboard with integrated reading lights
- King-size pillows and fine Egyptian cotton linens
- Nightstands with 220V power and USB outlets
- Desk/bar area with refrigerator and integrated power outlets
- Custom shelving and bar amenities
- Nespresso® coffee machine
- 65" Ultra-thin OLED TV
- Personal Safe
- Full-length mirror
- Blackout drapery and sheers
- Double vanity with back-lit mirrors
- Full Jacuzzi® bathtub
- Separate half-bath / powder room for guests
- Separate Water Closet with wash basin
- Glass-enclosed rain head shower with both overhead and handheld showerheads
- ETRO terry robes, slippers and bath amenities
- Electronic "Do Not Disturb" Doorbell
- Storage Closet for Expedition Gear located in corridor adjacent to suite
- 24-hour Butler Service

PENTHOUSE SUITE 457 SQ. FT. (42.5 SQ. M.) PLUS 77.5 SQ.FT.(7.2 SQ.M.) VERANDAH

PS

- Spacious living area featuring chaise sofa
- King-size bed (convertible to two twin beds) featuring upholstered headboard with integrated reading lights
- King-size pillows and fine Egyptian cotton linens
- Nightstands with 220V power and USB outlets
- Height-adjustable dining/coffee table
- Desk/bar area with refrigerator and integrated power outlets
- Custom shelving and bar amenities
- Nespresso® coffee machine
- 55" Ultra-thin OLED TV
- Personal Safe
- Full-length mirror
- Blackout drapery and sheers
- Double vanity with back-lit mirrors
- Separate Water Closet with wash basin
- Glass-enclosed rain head shower with both overhead and handheld showerheads
- ETRO terry robes, slippers and bath amenities
- Electronic "Do Not Disturb" Doorbell
- Storage Closet for Expedition Gear located in corridor adjacent to suite
- 24-hour Butler Service

DELUXE SUITES 304 SQ. FT. (28.3 SQ. M.) PLUS 51.5 SQ.FT.(4.8 SQ.M.) VERANDAH

S1 | S2 | S3 | S4 | S5 | S6 | S7

- King-size bed (convertible to two twin beds) featuring upholstered headboard with integrated reading lights
- King-size pillows and fine Egyptian cotton linens
- Nightstands with 220V power and USB outlets
- Height-adjustable dining/coffee table
- Desk/bar area with refrigerator and integrated power outlets
- Custom shelving and bar amenities
- Nespresso® coffee machine
- 55" Ultra-thin OLED TV
- Personal Safe
- Full-length mirror
- Blackout drapery and sheers
- Double vanity with back-lit mirrors
- Separate Water Closet with wash basin
- Glass-enclosed rain head shower with both overhead and handheld showerheads
- ETRO terry robes, slippers and bath amenities
- Electronic "Do Not Disturb" Doorbell
- Storage Closet for Expedition Gear located in corridor adjacent to suite
- 24-Hour Butler Service

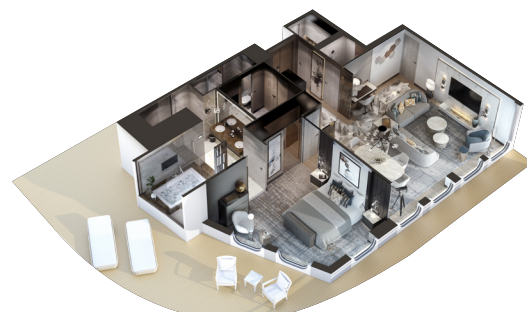
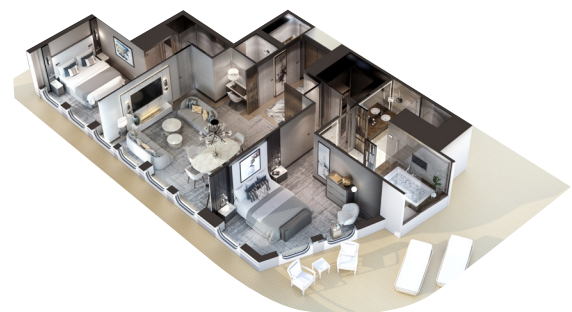

*Restrictions apply. Services are nontransferable. There are no credits given for forfeited services. **Please note:** Penthouse and stateroom photos shown are examples of what is available and do not necessarily reflect all rooms or latest refurbishments, including but not limited to staterooms for guests with disabilities.